

How to use your Lilly Insulin Prefilled Pen

Pen Parts

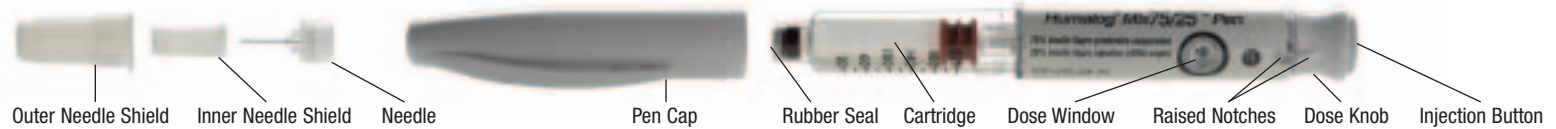

Preparing and Priming

Remove Pen Cap

Be sure to check your insulin:

- Correct Type
- Within Expiry Date
- Appearance (see reverse side)



For Cloudy Insulin:

- Roll the Pen gently 10 times
- Also, gently turn the Pen up and down 10 times until the insulin is evenly mixed

Attach Needle:

- Clean the rubber seal with alcohol swab
- Push capped needle straight onto Pen
- Screw on shielded needle until secure

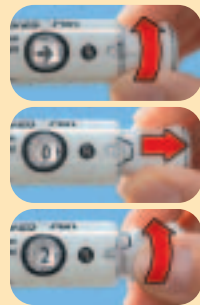

Set the Prime Dose

- Turn the dose knob clockwise (to the right) until you see an arrow (→) in the center of the window and the raised notches on the Pen and dose knob are in line
- Pull out the dose knob in the direction of the arrow until a "0" is seen in the dose window
- Turn the dose knob clockwise until a "2" is seen in the dose window



Prime the Pen

With the needle pointed up:

- Tap the clear cartridge holder gently with your finger so that any air bubbles collect near the top
- Push in the injection button completely. Keep pressing and continue to hold **firmly** while counting **slowly** to "5". You should see either a drop or a stream of insulin come out of the tip of the needle
- If insulin does not come out of the tip of the needle repeat the priming steps
- Priming is complete when the insulin flow appears at the needle tip and a diamond (◆) is seen centered in the dose window

Set Your Dose and Inject

Every Time You Inject

- Use a new needle
- Prime to make sure the Pen is ready to dose
- Make sure you received a full dose
- Remove the needle immediately after your injection

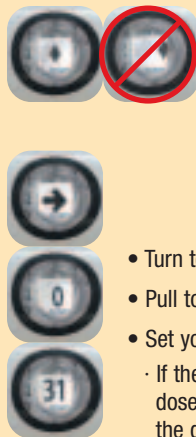

Set Your Dose

A diamond must be seen in the center of the dose window before setting your dose

If you do not see a diamond in the center of the dose window the Pen has not been primed correctly and you are not ready to set your dose. Before continuing repeat the priming steps

- Turn to the arrow (→)
- Pull to "0"
- Set your desired dose
- If the dose you have dialed is too high, simply turn the dose knob backward until the correct dose is seen in the dose window

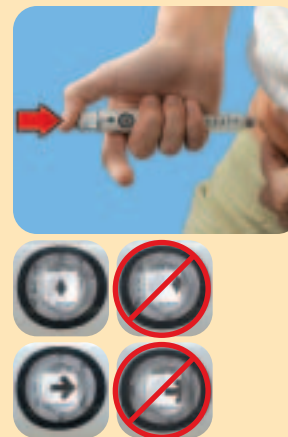

Injecting

Do not inject a dose unless the Pen is primed just before the injection or you may get too much or too little insulin

- Prepare the skin and use the injection technique recommended by your healthcare professional
- Insert the Needle
- Place your thumb on the injection button and push **firmly** until the dose knob is pushed in completely
- Hold the injection button in and count **slowly** to "5" to deliver the full dose
- Make sure that you received a full dose by checking that the injection button has been completely pushed in and you can see a diamond (◆) or an arrow (→) in the center of the dose window

Important Notes/Questions and Answers

Read and follow all of these instructions carefully. Also, read the User Manual and the Information for the Patient inserts enclosed in your pen box. If you do not follow these instructions completely, you may get too much or too little insulin.

Preparing and Priming

- Always examine the appearance of your insulin before injecting a dose.
 - Cloudy insulin should appear uniformly cloudy or milky after mixing. Do not use if the insulin substance (the white material) remains visibly separated from the liquid after mixing, if there are clumps, or if solid white particles stick to the bottom or walls of the cartridge giving a frosted appearance.
 - Clear insulin should appear clear and colorless. Do not use if it appears cloudy, thickened, or slightly colored, or if solid particles are visible.
- The Pen must be primed before each injection to make sure the Pen is ready to dose. Performing the priming step is important to confirm that insulin comes out when you push the injection button, and to remove any air that may collect in the insulin cartridge during normal use.
 - If you do not prime, you may get too much or too little insulin.
 - Note: A small air bubble may remain in the cartridge after completion of the priming step. If you have properly primed the Pen, this small air bubble will not affect your insulin dose.
- Always use a new needle for each injection.
 - This device is suitable for use with Becton Dickinson and Company's insulin pen needles.
 - Check with your Healthcare Professional for correct needle size.
- Do not push the injection button without a needle attached.

Setting a Dose and Injecting

- **Caution:** Do not push in the injection button while setting your dose. If you accidentally push the injection button while setting your dose, you must prime the Pen again before injecting your dose.
- **Caution:** Do not attempt to change the dose after you begin to push in the injection button. Failure to follow these instructions carefully may result in getting too much or too little insulin.
- If you do not see the diamond (◆) or an arrow (➔) in the center of the dose window after an injection, you did not get a full dose. Contact your Healthcare Professional for additional instruction.
- A dose greater than the number of units left in the cartridge cannot be dialed. (See "Questions and Answers")
- The effort required to push in the injection button may increase while you are injecting your insulin dose. If you cannot completely push in the injection button, refer to "Questions and Answers".
- The numbers on the clear cartridge holder give an estimate of the amount of insulin remaining in the cartridge. Do not use these numbers for measuring an insulin dose.



insulin lispro injection (rDNA origin)



75% insulin lispro protamine suspension
25% insulin lispro injection (rDNA origin)

Storage

- Do not store or dispose of the Pen with a needle attached. Storing the Pen with the needle attached may allow contamination, insulin to leak from the Pen, and air bubbles to form in the cartridge. Additionally, with suspension (cloudy), the insulin's crystals may clog the needle.
- Dispose of empty Pens and used needles as instructed by your Healthcare Professional or institutional policies.
- Pens In-Use
 - Humalog/Humulin Pens in-use should NOT be refrigerated but should be kept at room temperature (below 86°F) away from direct heat and light.
 - When in use, unrefrigerated Pens must be discarded after the following days, even if they still contain insulin:

| | |
|------------------|---------|
| Humalog | 28 days |
| Humalog Mix75/25 | 10 days |
| Humulin N | 14 Days |
| Humulin 70/30 | 10 Days |
 - Do not use a Pen after the expiration date stamped on the label.
- Pens Not-In-Use (unopened)
 - Humalog/Humulin Pens not in-use should be stored in a refrigerator but not in the freezer.
- Do not use a Pen if it has been frozen.

General

- Prime to make sure the Pen is ready to dose.
- Use a new needle for each injection.
 - Be sure a new needle is completely attached to the Pen before priming, setting (dialing) the dose and injecting your insulin.
- Make sure you get a full dose.
 - To make sure you get a full dose, you must push the injection button all the way down until you see a diamond (◆) or an arrow (➔) in the center of the dose window.
- Do not share your pen.
- Keep your pen out of the reach of children.
- Always carry an extra Pen in case your pen is lost or damaged.
- This Pen is not recommended for use by blind or visually impaired persons without the assistance of a person trained in the proper use of the product.
- Any changes in insulin should be made cautiously and only under medical supervision.

If you have questions about pens, call Lilly at
1-800-LILLYRX (1-800-545-5979), Monday–Friday,
9:00 a.m. to 5:00 p.m. EST. Pen needles
sold separately at your local pharmacy.

HI-34147 PRINTED IN USA. 3000110577 030530
COPYRIGHT © 2005, ELI LILLY AND COMPANY. ALL RIGHTS RESERVED.

Questions and Answers

Problem

Actions

- 1. Dose dialed and injection button pushed without a needle attached**

To obtain an accurate dose you must:

 - 1) Attach a new needle.
 - 2) Push in the injection button completely (even if a "0" is seen in the dose window) until a diamond (◆) or an arrow (➔) is seen in the center of the dose window.
 - 3) Prime the Pen.
- 2. Insulin does not come out of the needle**

To obtain an accurate dose you must:

 - 1) Attach a new needle.
 - 2) Push in the injection button completely (even if a "0" is seen in the dose window) until a diamond (◆) or an arrow (➔) is seen in the center of the dose window.
 - 3) Prime the Pen. (See "Priming the Pen")
- 3. Wrong dose (too high or too low) dialed**

If you have not pushed in the injection button, simply turn the dose knob backwards or forward to correct the dose.
- 4. Not sure how much insulin remains in the cartridge**

Hold the Pen with the needle end pointing down. The scale (20 units between marks) on the clear cartridge holder shows an estimate of the number of units remaining. These numbers should not be used for measuring an insulin dose.
- 5. Full dose cannot be dialed**

The Pen will not allow you to dial a dose greater than the number of insulin units remaining in the cartridge.

For example, if you need 31 units and only 25 units remain in the Pen you will not be able to dial past 25. Do not attempt to dial past this point. (The insulin that remains is unusable and not part of the 300 units.) If a partial dose remains in the Pen you may either:

 - 1) Give the partial dose and then give the remaining dose using a new pen, or,
 - 2) Give the full dose with a new Pen.
- 6. A small amount of insulin remains in the cartridge but a dose cannot be dialed**

The Pen design prevents the cartridge from being completely emptied. The Pen has delivered the full 300 units of usable insulin.
- 7. Cannot completely push in the injection button when priming the Pen or injecting a dose**
 - 1) Needle is not attached or is clogged.
 - a. Attach a new needle.
 - b. Push in the injection button completely (even if a "0" is seen in the dose window) until a diamond (◆) or an arrow (➔) is seen in the center of the dose window.
 - c. Prime the Pen.
 - 2) If you are sure insulin is coming out of the needle, push the injection button more slowly to reduce the effort needed and maintain a constant pressure until the injection button is completely pushed in.

